



**Electrolux**  
PROFESSIONAL

## Handling System for Rack Type Trays Cord Conveyor Curve 90° with Legs

ITEM # \_\_\_\_\_

MODEL # \_\_\_\_\_

NAME # \_\_\_\_\_

SIS # \_\_\_\_\_

AIA # \_\_\_\_\_



865184 (HSCT90CCT)

Cord conveyor for trays, 90°  
curve Unit with legs  
(wxd=700x700mm)

### Short Form Specification

#### Item No. \_\_\_\_\_

Constructed in 304 AISI stainless steel. Two cords in 15mm reinforced polyurethane. Square 40x40mm tubular legs on height-adjustable feet. Designed for trays up to 375x530mm.

### Main Features

- Available as optional accessory a remote easy-to reach emergency-stop buttons fitted where required.
- Range allows a large number of conveyor combinations.
- Wall mounted on request.
- Anti tray-jamming system.
- Other angles available on request.
- No stacking trays in curves increase the speed of the outside cord.

### Construction

- All surfaces smooth with polished finish.
- Constructed in AISI 304 1,5mm stainless steel.
- 15mm reinforced polyurethane cord, for smooth and easy running.
- For trays up to 375x530mm.
- Stainless steel square 40x40mm tubular legs.
- Free-standing construction delivered with 40x40mm legs.
- Stainless steel plain conveyor base for easy cleaning.

### Optional Accessories

- Emergency switch for cord conveyor PNC 865141 ☐
- Kit for cord welding PNC 865143 ☐

APPROVAL: \_\_\_\_\_



Experience the Excellence  
[www.electroluxprofessional.com](http://www.electroluxprofessional.com)



**Electrolux**  
PROFESSIONAL

## Handling System for Rack Type Trays Cord Conveyor Curve 90° with Legs

### Key Information:

External dimensions, Width:

865184 (HSCT90CCT) 700 mm

External dimensions, Depth: 700 mm

External dimensions, Height: 910 mm

Net weight: 28 kg

Basin material: Stainless Steel AISI 304 -  
EN 1.4301

Front

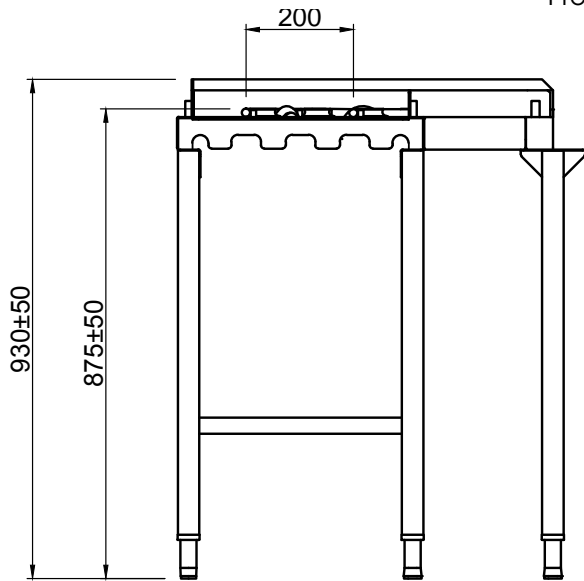

Top

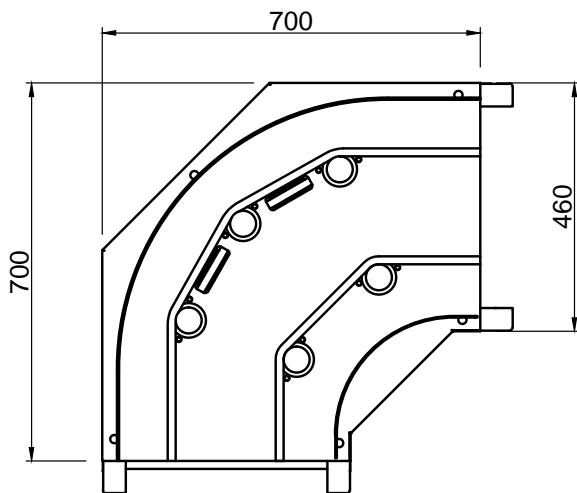

Handling System for Rack Type  
Trays Cord Conveyor Curve 90° with Legs

The company reserves the right to make modifications to the products  
without prior notice. All information correct at time of printing.

2025.07.16